

1/8scale YAMAHA SEROW225(2LN)

- 切断
- ⋯ 山折り
- - - 谷折り
- ▨ 切り抜き
- × 糊付け位置
- △ 折り返して接着

い〜すのおもちゃ箱
<http://www.saturn.dti.ne.jp/~eastern/>

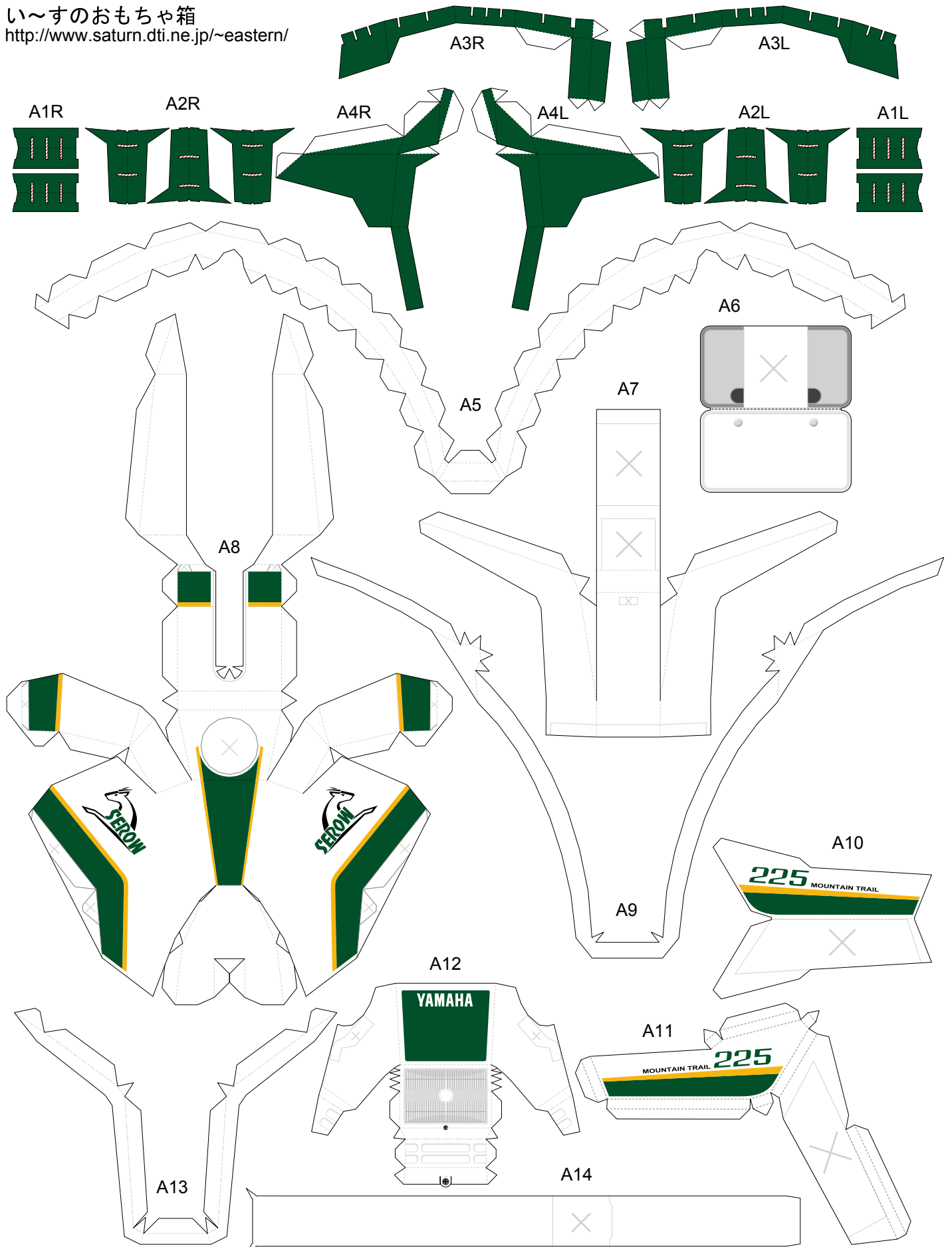

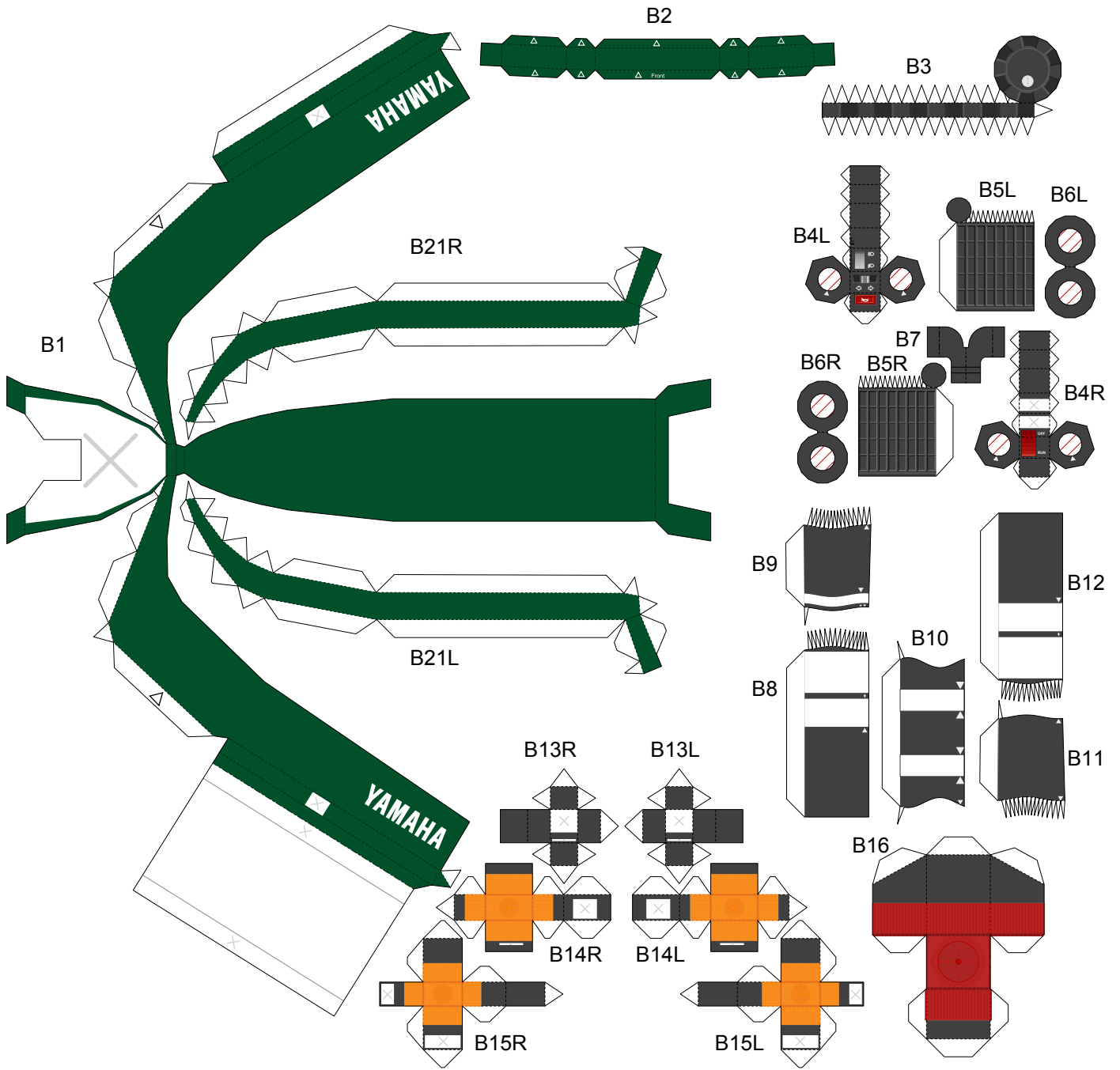

B17

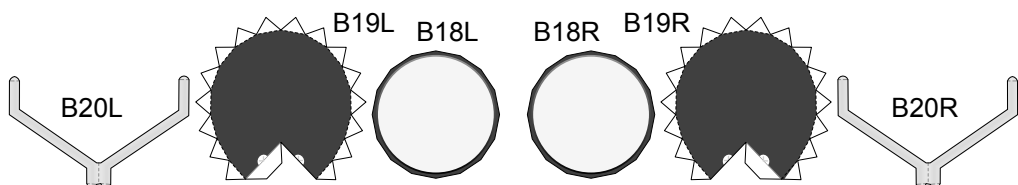
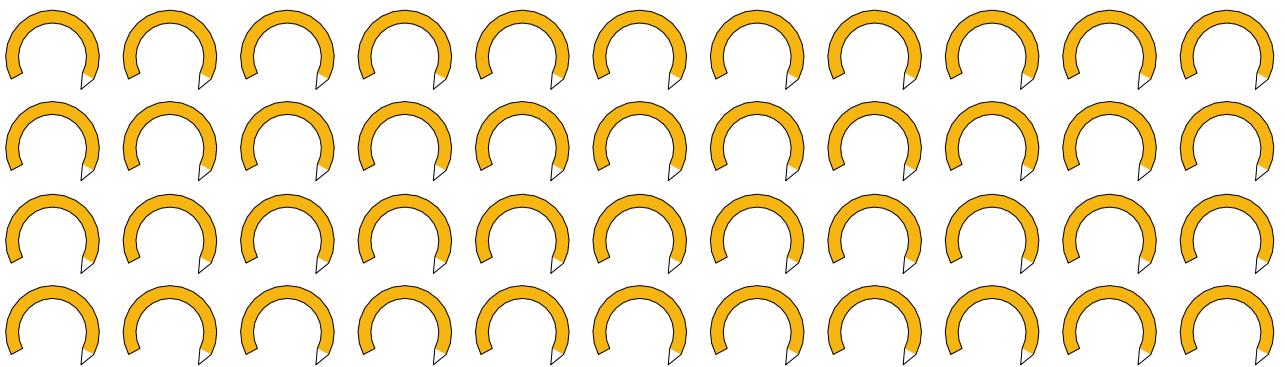

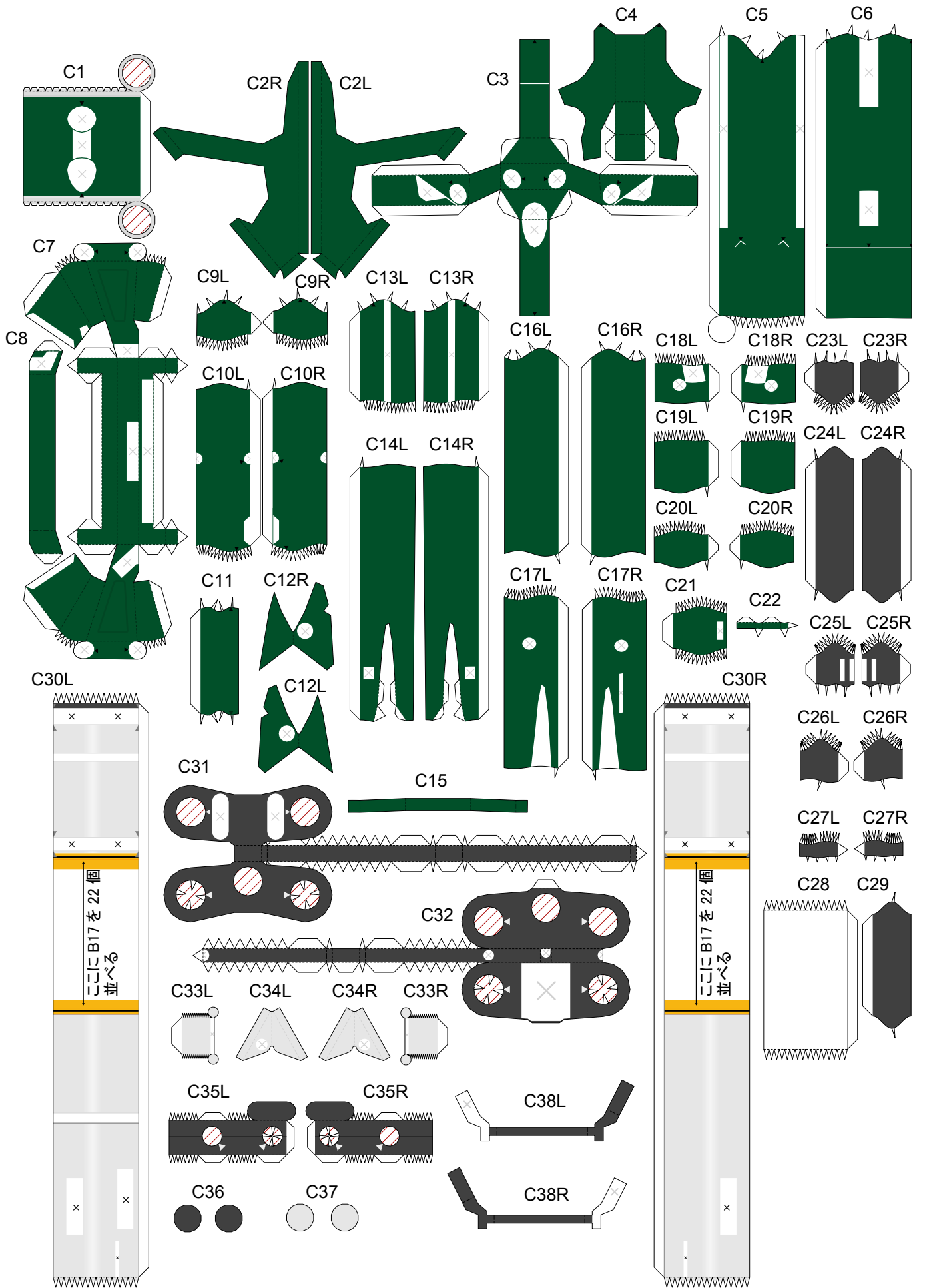

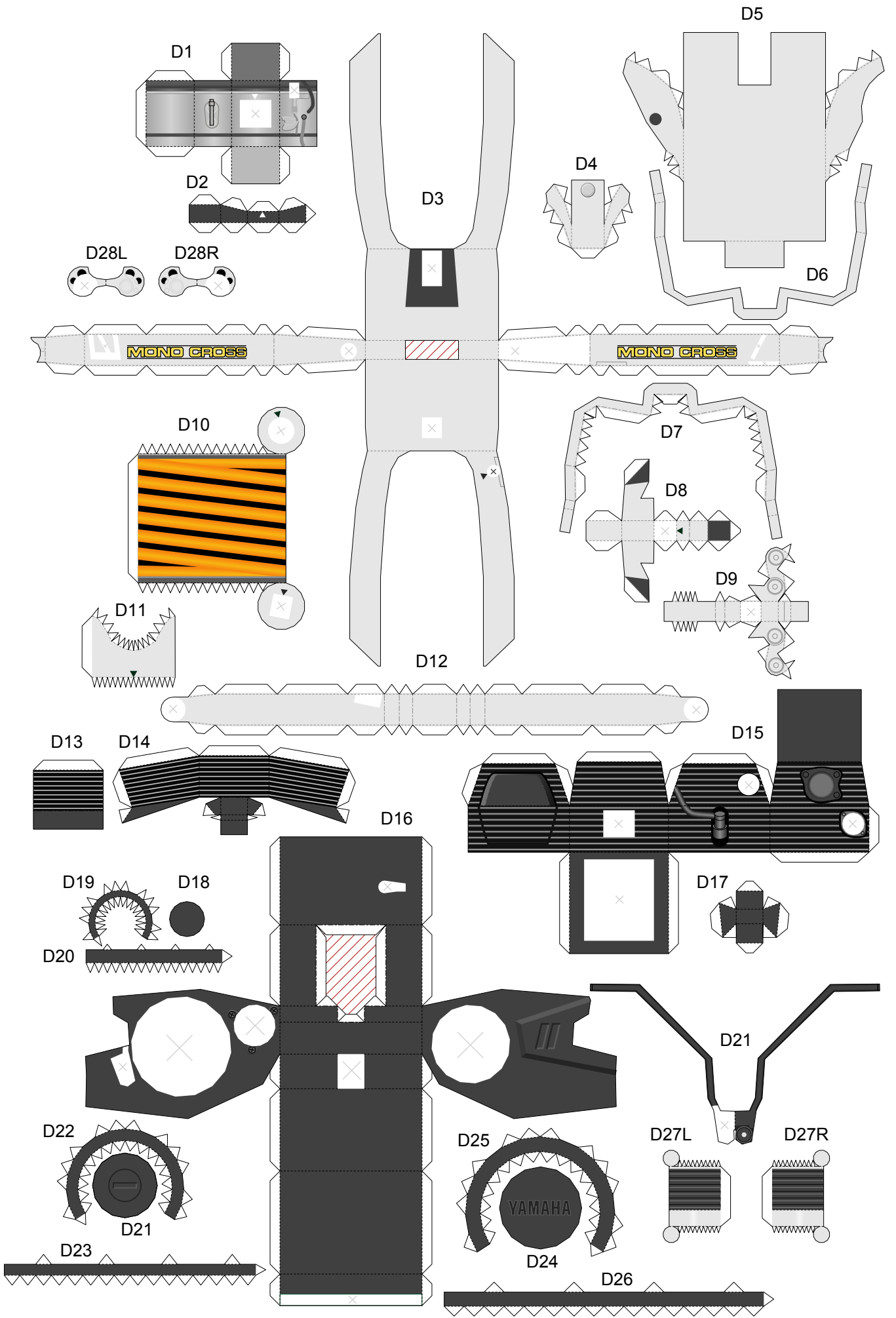

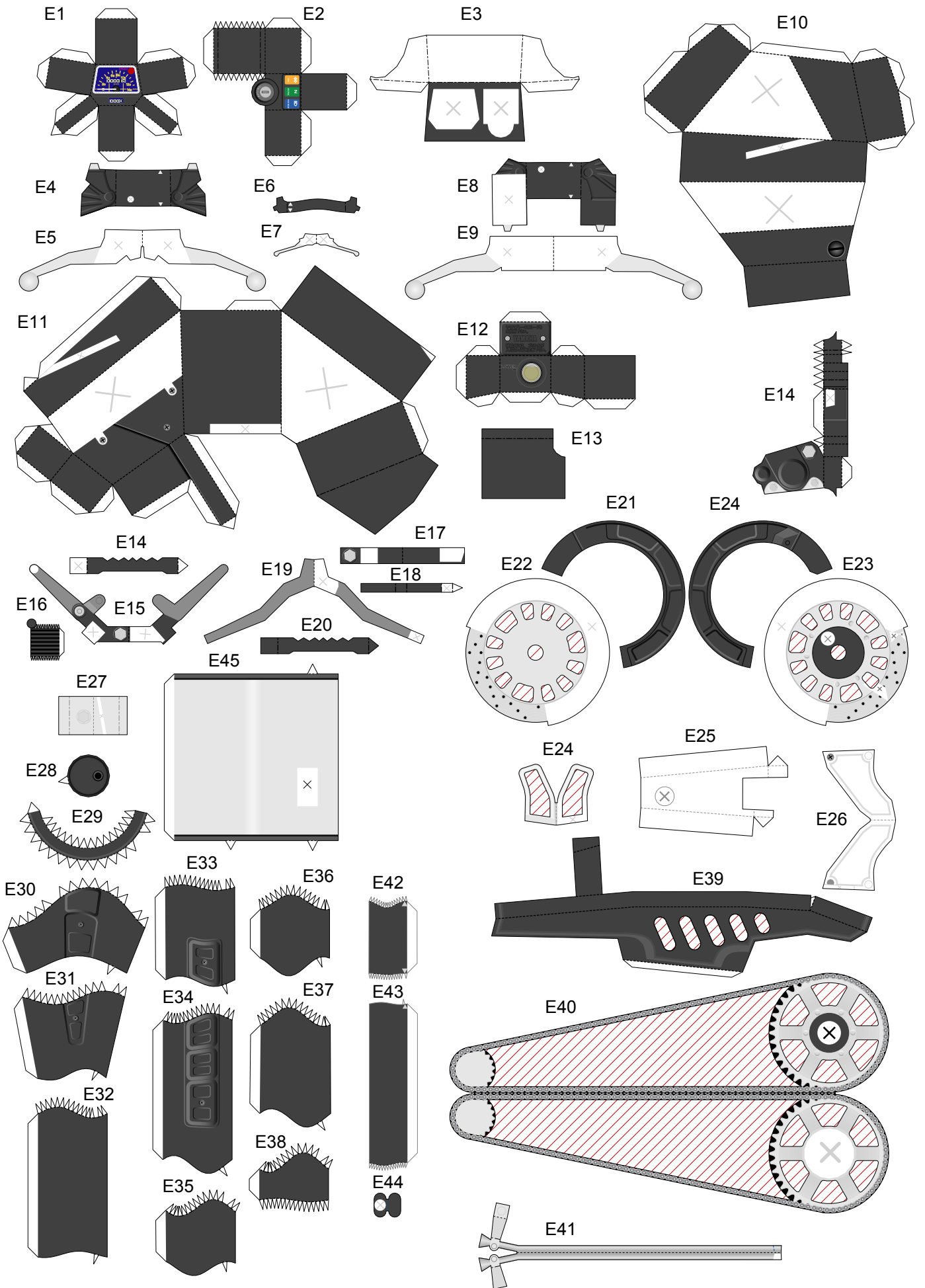

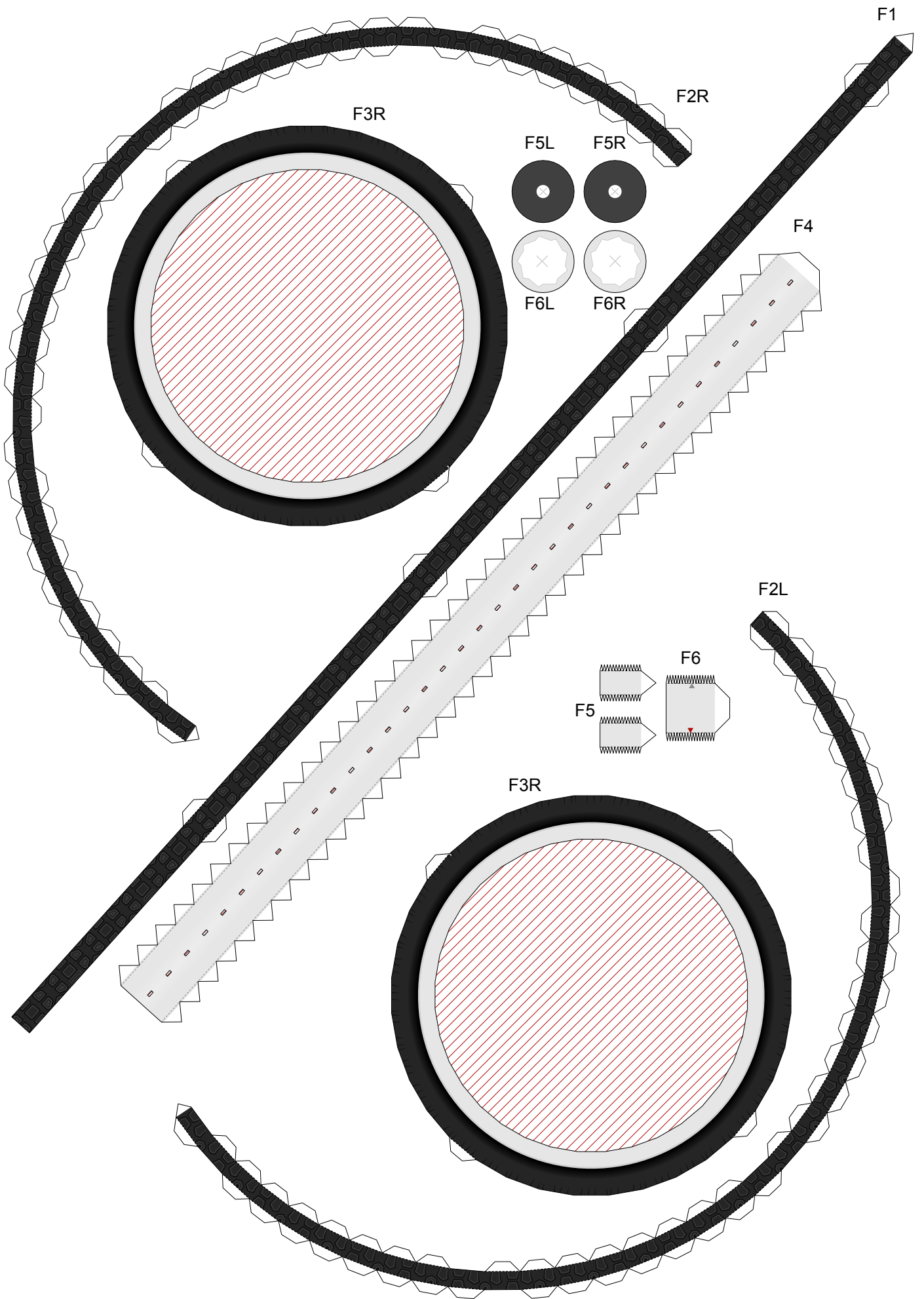

このページの部品の組み立て方

1. 切り抜き指示の場所を切り取る
2. 中央の線で山折りにして表面・裏面を接着する。
3. 表から部品を切り取る。

G3

表面

裏面

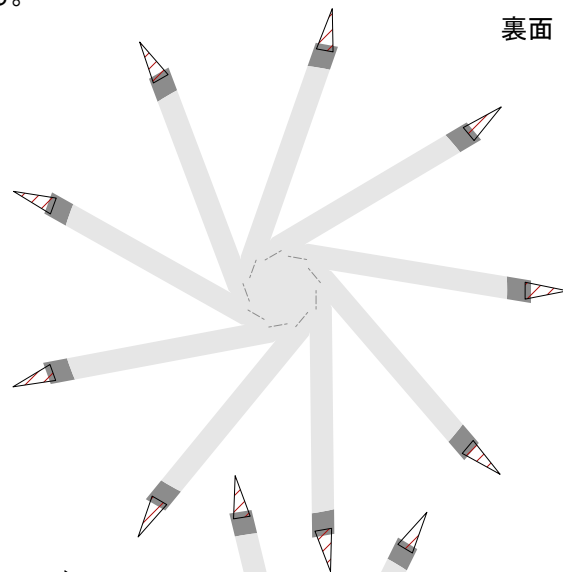
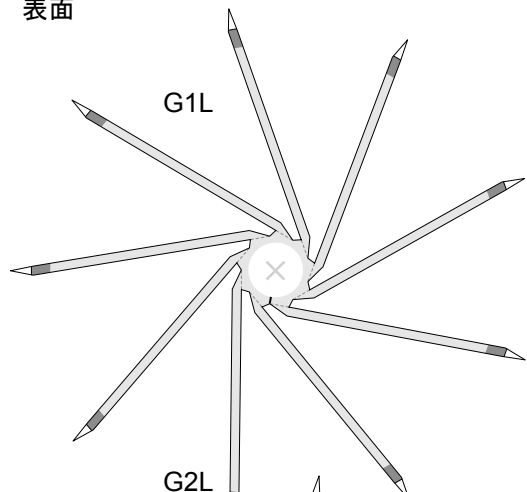

×

●

G4

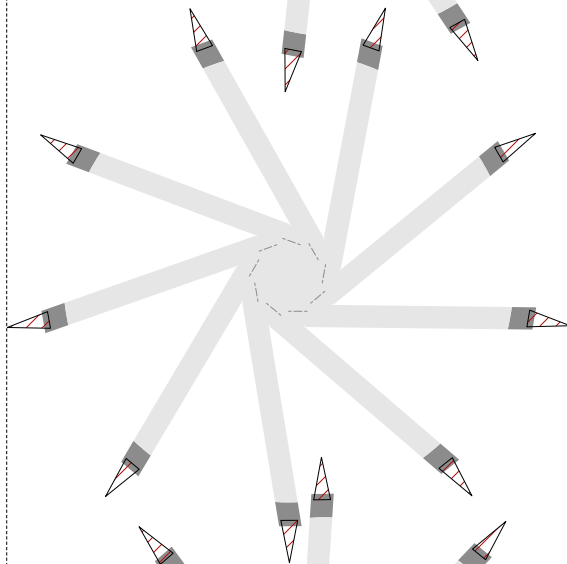
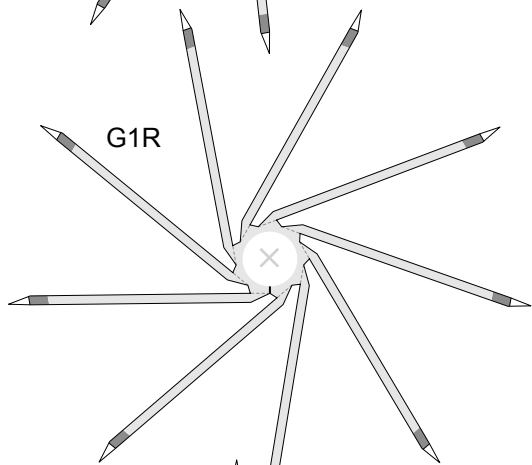
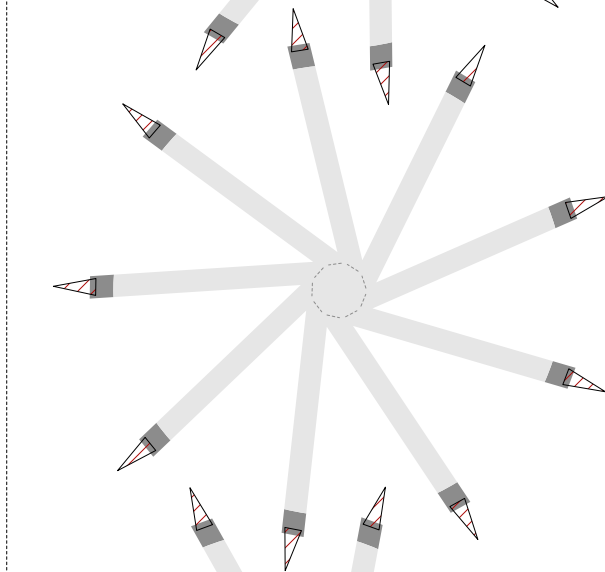
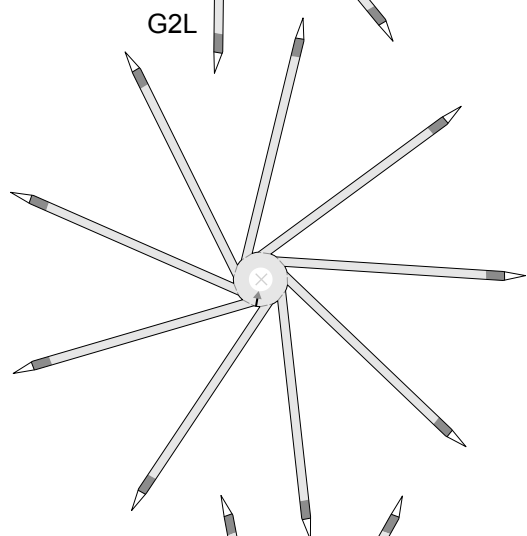

G2R



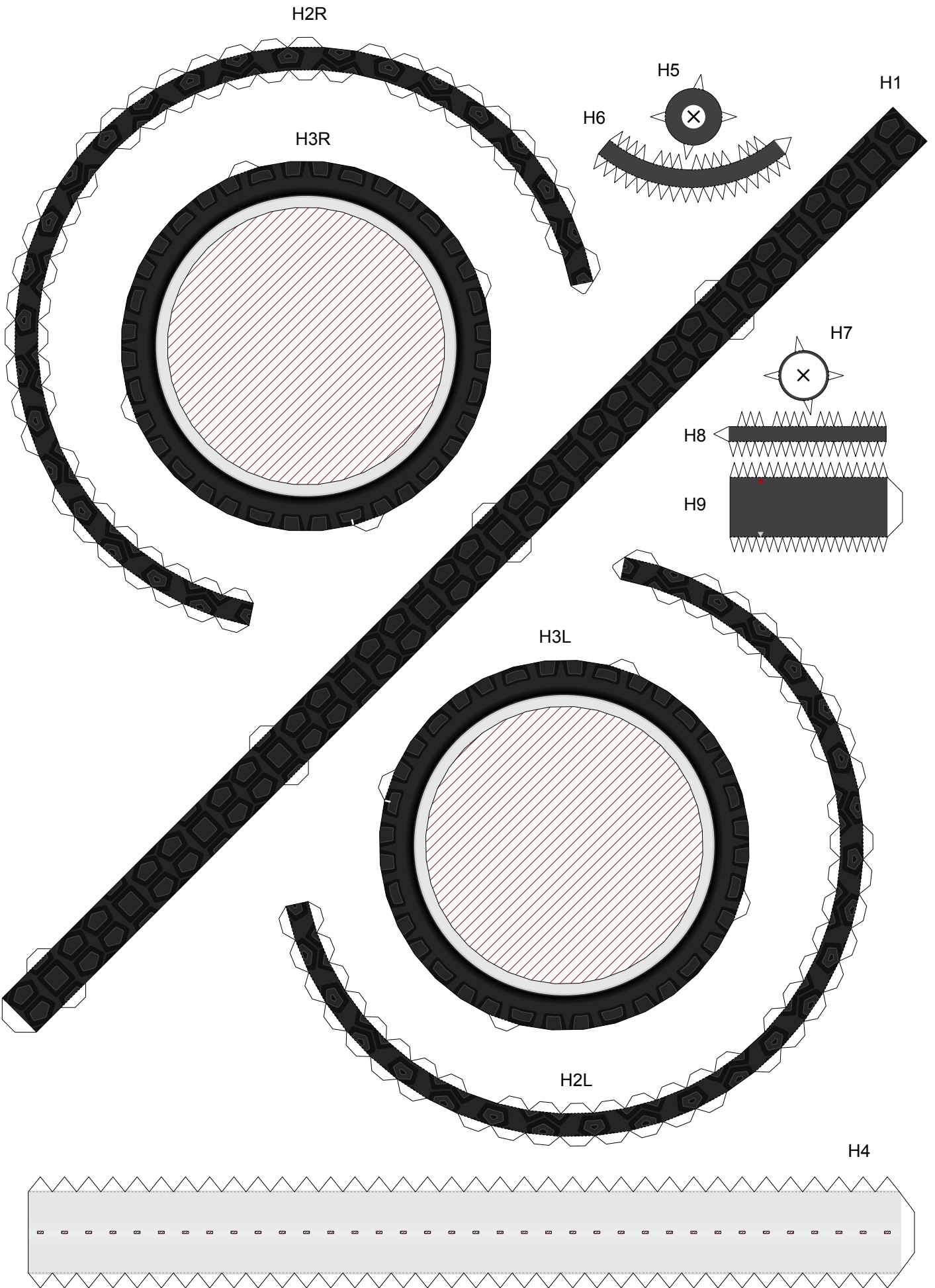

このページの部品の組み立て方

1. 切り抜き指示の場所を切り取る
2. 中央の線で山折りにして表面・裏面を接着する。
3. 表から部品を切り取る。

I3



I4

I1L

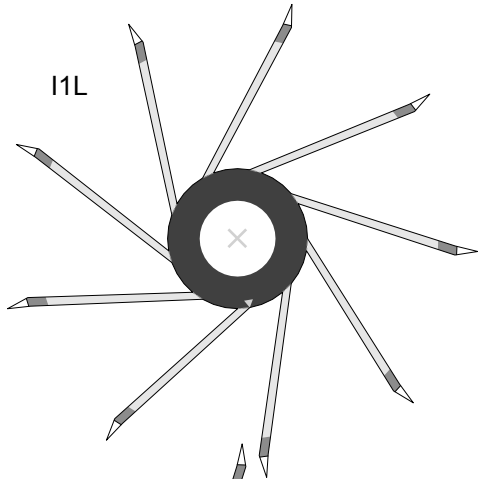

I2L

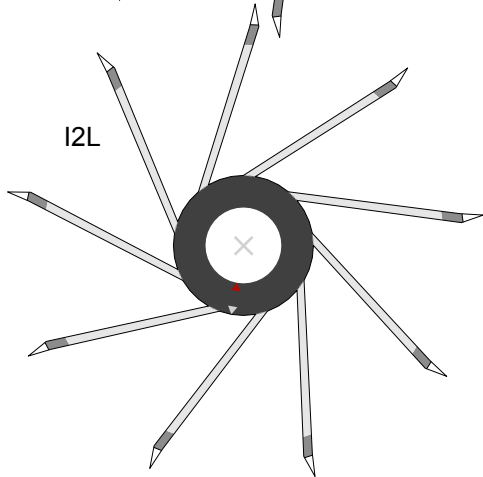

I2R

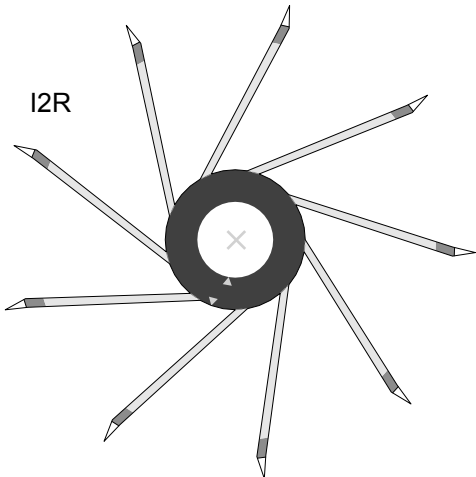

I5

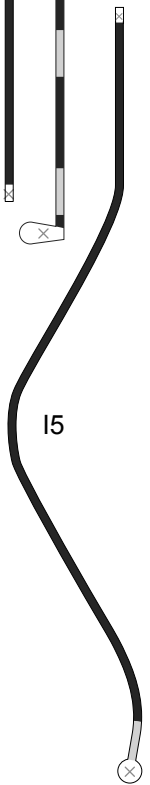

I1R

